



APR 22 2016

COR/2016/01342

Mr. Richard Roche
Town of Logy Bay-Middle Cove-Outer Cove
744 Logy Bay Road
Logy Bay, NL
A1K 3B5

Dear Mr. Roche:

RE: Logy Bay-Middle Cove-Outer Cove Municipal Plan Amendment No. 18, 2015, and Development Regulations Amendment No. 28, 2015

I am pleased to inform you that the **Town of Logy Bay-Middle Cove-Outer Cove Municipal Plan Amendment No. 18, 2015 and Development Regulations Amendment No. 28, 2015**, adopted by Council on the **9th day of November, 2015**, have now been registered.

Council must publish a notice in the **Newfoundland and Labrador Gazette** within 10 days of this letter. The amendments come into effect on the date that this notice appears in the NL Gazette. The notice must also appear in a local newspaper.

The NL Gazette is published every Friday. **Notices must be submitted a week in advance.** Council can submit the notice by email queensprinter@gov.nl.ca, by fax (729-1900) or by mail (Queen's Printer, P.O. Box 8700, St. John's, and NL, A1B 4J6).

Council's registered copies of the amendment are enclosed. As they are legal documents, they should be reserved in a safe place.

Sincerely,



Corrie Davis, MCIP
Manager, Land Use Planning

cc: Reginald Garland, MCIP

Encls.

TOWN OF LOGY BAY-MIDDLE COVE-OUTER COVE

MUNICIPAL PLAN 2005-2015



DEVELOPMENT REGULATIONS AMENDMENT No. 28, 2015

“RESIDENTIAL SUBDIVISION AREA” to “PUBLIC USE”

Roman Catholic Cemetery off Cemetery Lane

September 2015

PLAN-TECH



ENVIRONMENT

URBAN AND RURAL PLANNING ACT
RESOLUTION TO APPROVE
TOWN OF LOGY BAY-MIDDLE COVE-OUTER COVE
DEVELOPMENT REGULATIONS AMENDMENT No. 28, 2015

Under the authority of section 16, section 17 and section 18 of the *Urban and Rural Planning Act 2000*, the Town Council of Logy Bay-Middle Cove-Outer Cove.

- a) Adopted the Town of Logy Bay-Middle Cove-Outer Cove Development Regulations Amendment No. 28, 2015, on the 9th day of November, 2015.
- b) Gave notice of the adoption of the Town of Logy Bay-Middle Cove-Outer Cove Development Regulations Amendment No. 28, 2015, by advertisement inserted on the 5th day and the 12th day of March, 2016, in the Telegram newspaper.
- c) Set the 23rd day of March at 7:30 p.m. at the Town Hall, Logy Bay-Middle Cove-Outer Cove for the holding of a public hearing to consider objections and submissions.

Now under section 23 of the *Urban and Rural Planning Act 2000*, the Town Council of Logy Bay-Middle Cove-Outer Cove approved the Town of Logy Bay-Middle Cove-Outer Cove Development Regulations Amendment No. 28, 2015 as adopted (or as amended).

SIGNED AND SEALED this 17th day of April, 2016

Mayor: _____
Clerk: _____



(Council Seal) Development Regulations/Amendment
REGISTERED
Number 2945-2016-031
Date April 22, 2016
Signature _____

URBAN AND RURAL PLANNING ACT
RESOLUTION TO ADOPT
TOWN OF LOGY BAY-MIDDLE COVE-OUTER COVE
DEVELOPMENT REGULATIONS AMENDMENT No. 28, 2015

Under the authority of Section 16 of the *Urban and Rural Planning Act 2000*, the Town Council of Logy Bay-Middle Cove-Outer Cove adopts the Town of Logy Bay-Middle Cove-Outer Cove Development Regulations Amendment No. 28, 2015.

Adopted by the Town Council of Logy Bay-Middle Cove-Outer Cove on the 9th day of November, 2015.

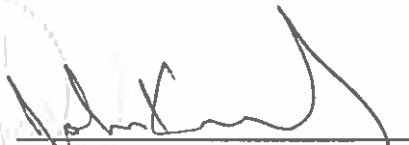
Signed and sealed this 1st day of April, 2016.

Mayor:  (Council Seal)
Clerk: 

CANADIAN INSTITUTE OF PLANNERS CERTIFICATION

I certify that the attached Town of Logy Bay-Middle Cove-Outer Cove Development Regulations Amendment No. 28, 2015 has been prepared in accordance with the requirements of the *Urban and Rural Planning Act*.



TOWN OF LOGY BAY-MIDDLE COVE-OUTER COVE

DEVELOPMENT REGULATIONS AMENDMENT No. 28, 2015

BACKGROUND

The Town of Logy Bay-Middle Cove-Outer Cove proposes to implement Development Regulations Amendment No. 28, 2015. The Land Use Zone Map has the Roman Catholic Cemetery off Cemetery Road zoned as Public Use. The 2005 Land Use Zone Map only zoned the physical extents of the cemetery. It has come to Council's attention that additional land owned by the Roman Catholic Church is planned for continuous expansion of the Cemetery.

The additional land owned by the Roman Catholic Church is currently zoned Residential Subdivision Area. The purpose of this Amendment is to re-zone church owned land required for expansion of the Cemetery from Residential Subdivision Area to Public Use.

St. John's Urban Region Regional Plan

The St. John's Urban Region Regional Plan Map has designated this area as Urban Development. The Urban Development designation allows for uses such as churches and cemeteries. It is determined that no amendment to the St. John's Urban Region Regional Plan is required.

PUBLIC CONSULTATION

During the preparation of this amendment, Council undertook the following initiative so that individuals and groups could provide input to the proposed Development Regulations Amendment. The Town Council of Logy Bay-Middle Cove-Outer Cove published a notice in *The Telegram* newspaper on September 26th, 2015, which stated that the amendment would be on display from September 26, to October 16, 2015 for residents to view and to provide any comments or concerns in writing to the Council concerning the proposed amendment. The Town also scheduled a Public Briefing meeting which was held on October 6, 2015. No comments or objections were received within the time stipulated in the notice.

AMENDMENT No. 28, 2015

The Town of Logy Bay-Middle Cove-Outer Cove Development Regulations are amended by:

- A) *Changing*** the highlighted area of land from “Residential Subdivision Area (RSA)” to “Public Use (PU)”, as shown on the attached portion of the Town of Logy Bay-Middle Cove-Outer Cove Land Use Zoning Map.

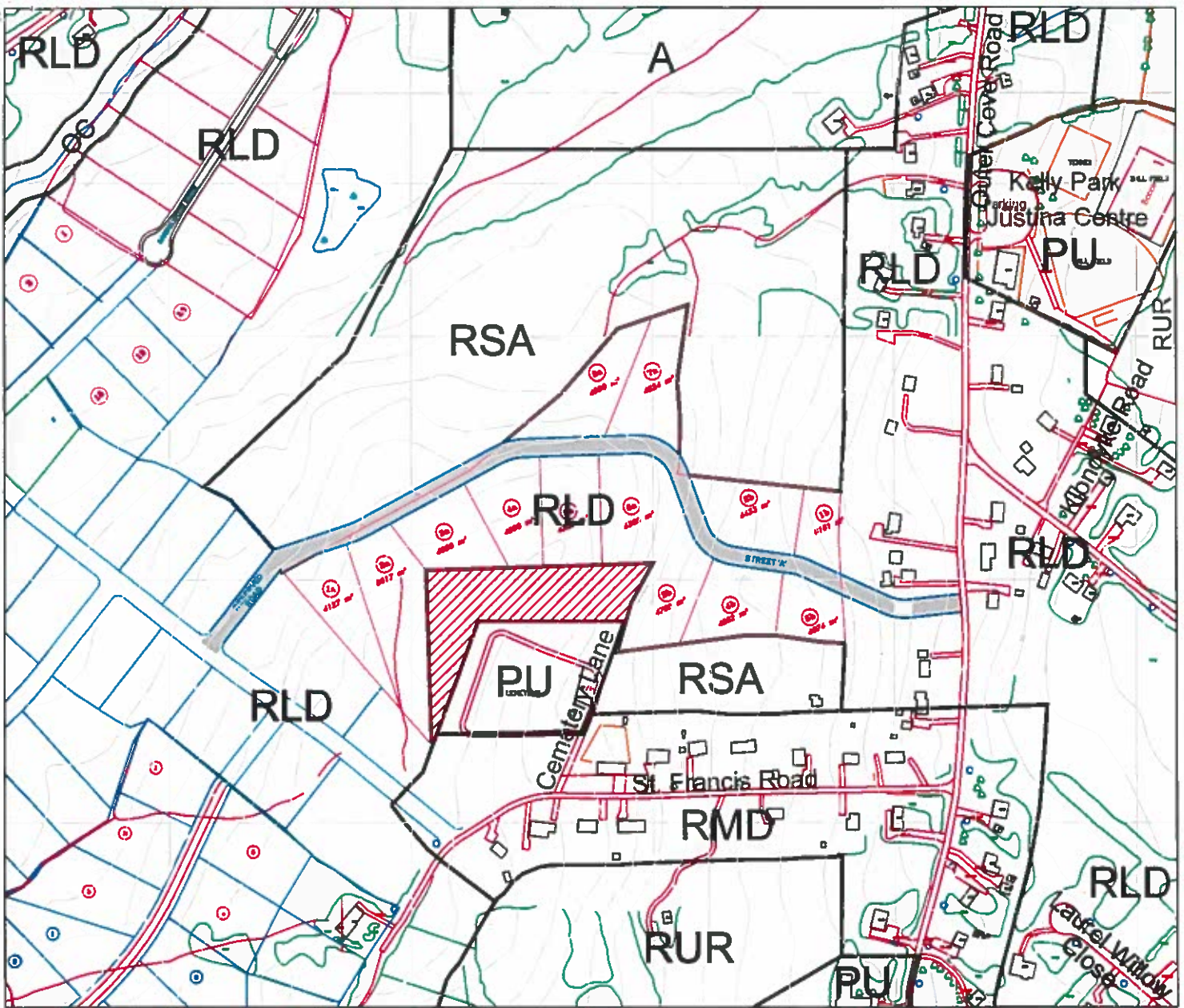

TOWN OF LOGY BAY-MIDDLE COVE-OUTER COVE

MUNICIPAL PLAN 2005-2015

LAND USE ZONE MAP

**DEVELOPMENT REGULATIONS
AMENDMENT No. 28, 2015**

Development Regulations/Amendments Dated at Logy Bay-Middle Cove-Outer Cove

REGISTERED

This 1st Day of April 2016

Number 2945-2016-031

Date April 22, 2016

Signature [Signature]

Seal

[Signature] Mayor

[Signature] Clerk



Area to be changed from: "Residential Subdivision Area" to "Public Use"

PLAN-TECH



ENVIRONMENT

Scale: 1:5000



I certify that the attached Town of Logy Bay-Middle Cove-Outer Cove Development Regulations Amendment No. 28, 2015 has been prepared in accordance with the requirements of the Urban and Rural Planning Act.