



PARCEL ID: \_\_\_\_\_ (internal use only)

744 Logy Bay Road  
Logy Bay, NL  
A1K 3B5

P: (709) 726-7930  
F: (709) 726-2178  
email: office@lbmccoc.ca  
www.lbmccoc.ca

## BUSINESS APPLICATION

**Important: The civic address must be clearly visible from the roadway prior to any permit being issued.**

Applicant Name: \_\_\_\_\_ Ph: (H) \_\_\_\_\_ (C) \_\_\_\_\_

Mailing Address: \_\_\_\_\_

Email Address: \_\_\_\_\_

Property Owner Name: \_\_\_\_\_ Ph: (H) \_\_\_\_\_ (C) \_\_\_\_\_

Mailing Address: \_\_\_\_\_

Civic Address of Proposed Business Location: \_\_\_\_\_

Business Name: \_\_\_\_\_ Ph: (H) \_\_\_\_\_ (C) \_\_\_\_\_

Civic & Mailing Address: \_\_\_\_\_

Home-Based Business  Yes  No      New Commercial Construction  Yes  No

**Please describe, in detail, your business/activities and attach plans/drawings if available:**

---

---

---

---

Number of people to visit home-based business daily/weekly \_\_\_\_\_

Number of anticipated parking spaces required \_\_\_\_\_

If a building or structure is required with this application, a current survey **must** be submitted with this application.

**IS SIGNAGE REQUIRED**  Yes  No

A separate application to be made if sign is required.



PARCEL ID: \_\_\_\_\_ (internal use only)

744 Logy Bay Road  
Logy Bay, NL  
A1K 3B5

P: (709) 726-7930  
F: (709) 726-2178  
email: office@lbmccoc.ca  
www.lbmccoc.ca

**EXISTING LAND USES (Check Appropriate Box(es) & Specify)**

- Residential     Crown Land     Commercial     Agricultural     Rural     Other
- RMD
- RLD

**PROPOSED MEANS OF ACCESS (DRIVEWAY)**

- Existing Access     New Access (Culvert)     Marine Drive

***\*New access driveways located on Marine Drive require a permit from the Department of Transportation and Works prior to any Town approval.***

I (We), \_\_\_\_\_, the Applicant(s) named herein, do solemnly declare the statements herein contained in this application are true and made with a full knowledge of the circumstances connected with the same, that the location and plot plan submitted correctly sets out the location of the development described in the said application. I (We) make this solemn declaration, conscientiously believing it to be true and with the full knowledge of the property owner, and knowing that it is of the same force and effect as if made under oath.

\*If you do not wish to have any personal information disclosed in a public document, please indicate such with your application submission.

Applicant Name (Print): \_\_\_\_\_

Applicant Signature: \_\_\_\_\_ Date: \_\_\_\_\_

Owner Name (Print): \_\_\_\_\_

Owner's Signature: \_\_\_\_\_ Date: \_\_\_\_\_

**PLOT PLAN FOR NEW COMMERCIAL CONSTRUCTION ONLY**

**DESCRIBE BUILDING/STRUCTURE**     N/A

Dimension: Length \_\_\_\_\_ x Width \_\_\_\_\_ (m/ft)    Area: \_\_\_\_\_ (m<sup>2</sup>/ft<sup>2</sup>)    Height: \_\_\_\_\_ (m/ft)

Heating Type: \_\_\_\_\_ # Washrooms: \_\_\_\_\_

Setbacks **must** be indicated on Plot Plan on the following page.



**PARCEL ID:** \_\_\_\_\_ (internal use only)

744 Logy Bay Road  
Logy Bay, NL  
A1K 3B5

P: (709) 726-7930  
F: (709) 726-2178  
email: office@lbmccoc.ca  
www.lbmccoc.ca

**Mandatory Information:**

1. Plans/diagrams.
2. Indicate and label location of new proposed building in relation to lot lines.
3. Indicate and label the location and dimensions of all pre-existing outbuildings/structures and distances between all buildings.
4. Indicate dimensions and specify metres or feet.
5. Submission of a current survey.

You may choose to use a copy of your current survey to plot the above in lieu of this form and attach with your application.

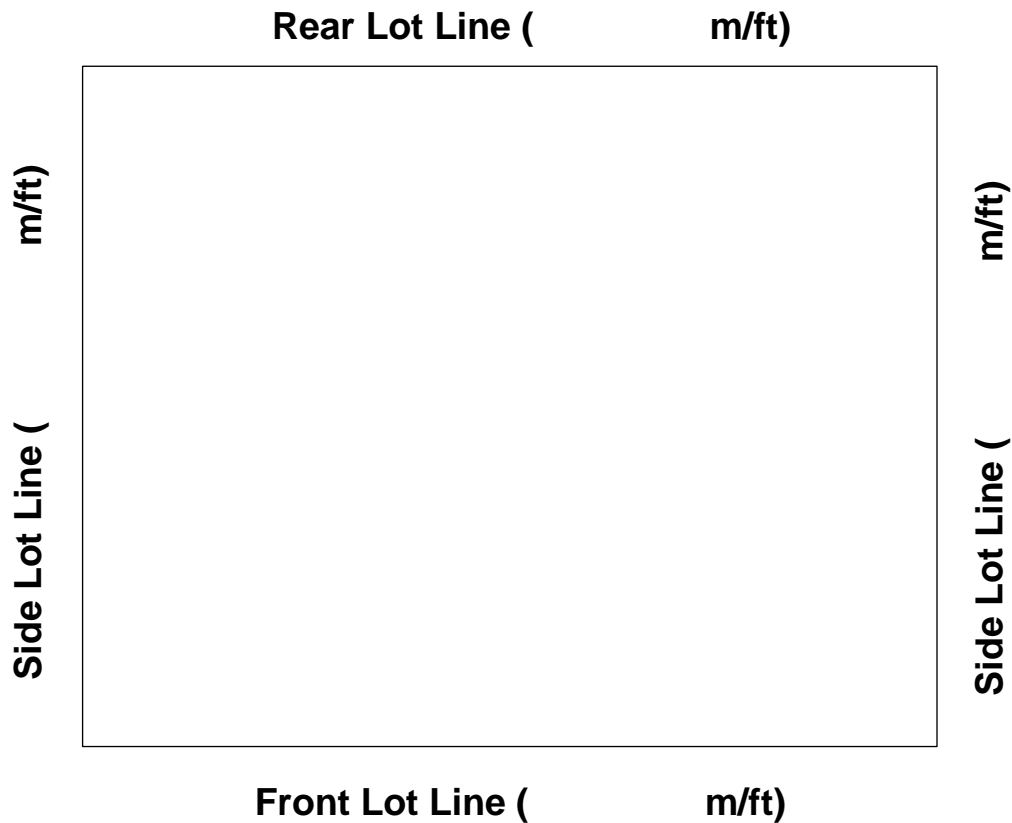

**Description (additional information):**

---

---

---

---